

Clean the interior

Clean the Filter Basket

- Lift the robot's head cover and remove the filter basket.
- Disassemble the filter basket and clean each part by rinsing.
- Put back the assembled filter basket after rinsing the water tank.

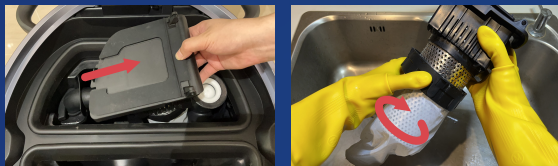

Clean Filter Caps

- Twist counterclockwise to remove the two filter caps.
- Take out the filter elements and rinse with clean water.
- Reassemble and reinstall filter caps after tank rinse.



Clean the Mesh Filter

- Twist counterclockwise to remove the two mesh filters.
- Rinse with clean water after removing visible dirt.
- Reinstall after rinsing the water tank.

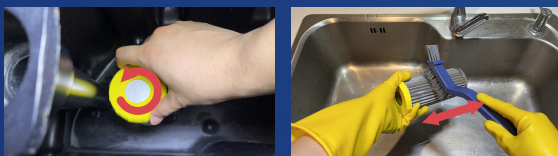

Rinse the Water Tank

- Place the water gun in the fresh water tank and turn on the tap.
- Rinse tank walls and gauge.
- Drain excess to wastewater tank by pulling lever.
- Close tap, put the water gun in wastewater tank.
- Move gun to wastewater tank and clean walls and gauge.
- Close tap and remove gun.
- Empty water using drainage pipe, secure cap tightly.
- Only the upper 10cm edge of the water tank can be rinsed.
- Do not wash tank's waterproof seal.

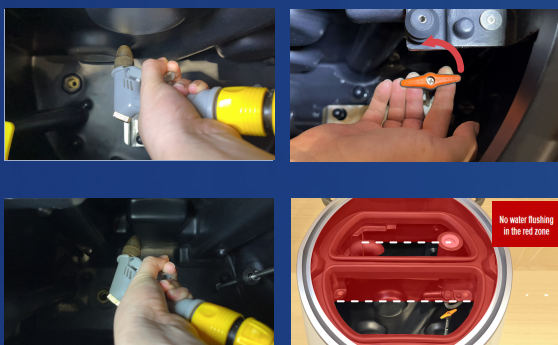

Clean Waste Suction Pipe

- Remove rubber elbow from tank.
- Insert water hose into waste suction pipe opening and flush.
- Reattach rubber elbow after rinsing.



Clean the bottom

Clean Side Brushes

- Pinch the base of the side brush and pull it down.
- Use a cutter to remove tangled hair.
- Hold the side brush and attach it to the axis for installation.

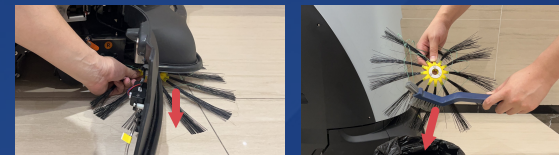

Clean the Dustbin

- Open side doors.
- Rotate the latch and pull out the two dust bins.
- Empty the trash, then push the dust bins back and close the side doors.



Clean the Roller Brush

- Press the button to unlock, then pull out the brush.
- Clean the bristles using a cutter and rinse the cloth part. • Push roller brush back and ensure button is locked.



Clean the Disk Brush

- Press and push down the nut to remove the disk brush.
- Use a stiff brush to clean the edges and remove debris.
- Lift the edge and securely attach the disk brush.



Clean the Squeegee

- While pressing the nut, pull out the squeegee blade sideways and wipe it clean.
- Clean any foreign objects from the metal groove of the squeegee.
- Press the nut to reattach the squeegee blade.



Clean the exterior

Wipe the machine's exterior

- Use a dry, damp cloth
- Wipe the exterior from top to bottom.



Clean the Bottom Wheel Assembly

- If floor has wheel marks, use adhesive dust pad.
- Switch the machine to manual mode.
- Slide back and forth on the dust pad to remove dust.



Wipe the Sensors

- Prepare a clean, soft cloth.
- Wipe the front and rear cameras in sequence.
- Wipe the overall collision shell and the top laser area.



Wipe the Head Cover Screen

- Use a clean, soft cloth.
- Wipe the screen in circles, moving from the inside to the outside.



Clean Workstation

- Disconnect power from the charging dock or workstation.
- Use a dry, damp cloth to wipe the exterior.
- Take out the foam from the water tray to rinse.

